

FORM No. 1:

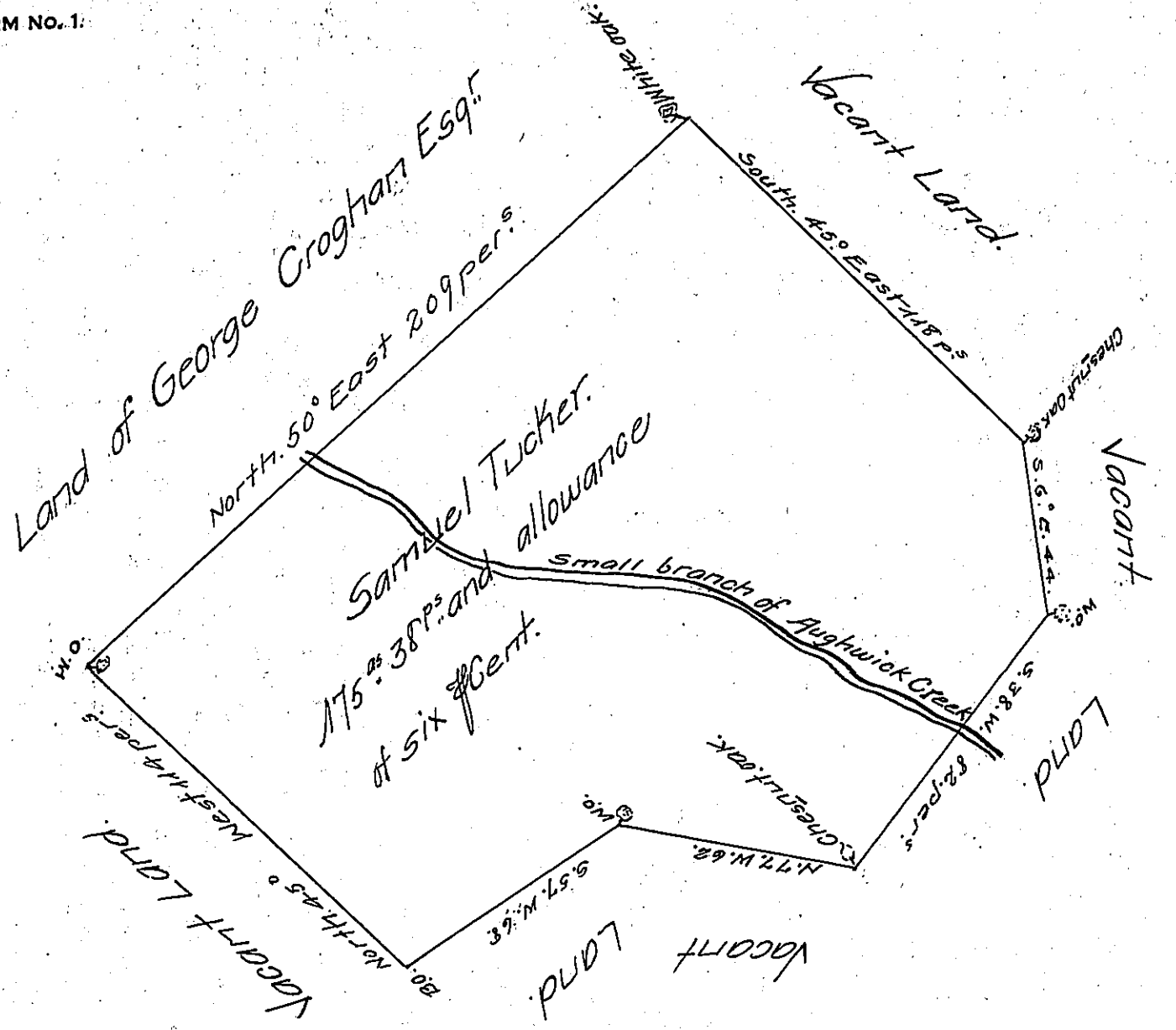

A Draught of a Tract of Land Situate on a small Branch of Aughwick in the County of Cumberland containing one hundred and seventy five Acres and 38 per. and the usual allowance of six Acres Cent for Roads &ca. Surveyed the third day of June 1765, in pursuance of a Warrant dated the thirty first day of May 1762.

Richard Tea Dep. Surveyor

To John Lukens Esq. Surveyor Genl

IN TESTIMONY that the above is a copy of the original remaining on file in the Department of Internal Affairs of Pennsylvania, made conformably to an Act of Assembly approved the 16th day of February 1833, I have hereunto set my hand and caused the Seal of said Department to be affixed at Harrisburg, this eighteenth day of April 1907.

*Geac R. Brown*  
Secretary of Internal Affairs.